

Instructions

FC40 Fluxgate Compass (P/N 22090245)

RC42 Rate Compass (P/N 22090237)

GENERAL

The FC40 and RC42 compasses are designed for connection to the SimNet network. They are equipped with 5,5 m (18 feet) of SimNet cable with connector. The compasses transmit the heading even if the autopilot is switched off.

INSTALLATION

The compass can be mounted on deck or bulkhead, athwart ship or along ship. Some of the products connected to the SimNet network may have a heading offset feature. This will compensate for the mechanical offsets resulting from the selected location and orientation of the compass.

If the connected products have no offset feature, the compass must be deck or bulkhead mounted athwart ship with the cable gland pointing aft.

Select a location that provides a solid mounting place free from vibration, and as close to the vessel's centre of roll and pitch as possible, i.e. close to the water line. It should

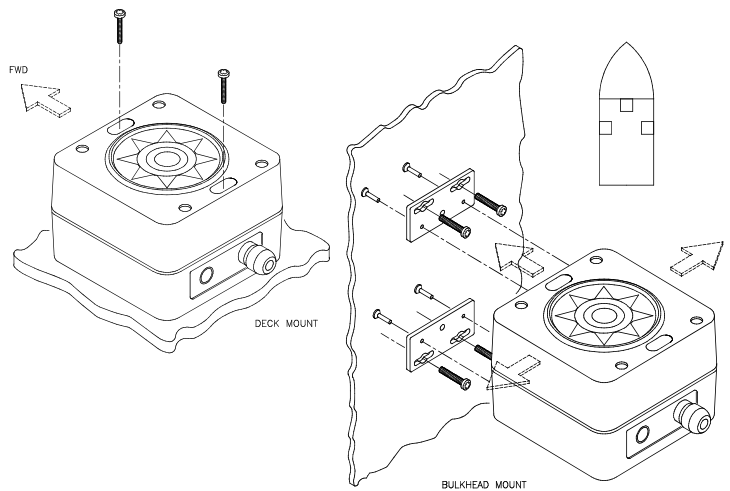

be as far as possible from disturbing magnetic interference e.g. engines (min. 2 meters), ignition cables, other large metal objects and particularly the autopilot drive unit. On steel hull boats it should be mounted 0.75-1 m above the wheel house on a non magnetic stand.

The compass face plate is the TOP. Never mount it upside down! Level the sensor as close to horizontal as possible.

Use the supplied mounting kit and drill holes through the centre of the slots.

ELECTRICAL CONNECTION

- Connect the compass to an available SimNet connector in the SimNet "backbone".
- When used as "stand alone" compass, connect an AT10 output on NMEA 0183 format, refer to drawing.

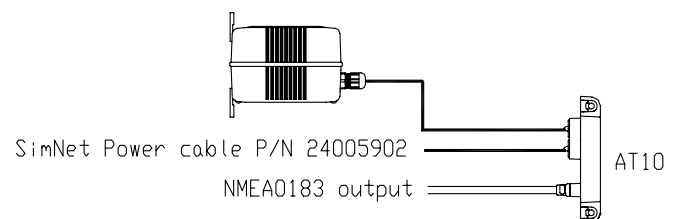

COMPASS CALIBRATION AND OFFSET ADJUSTMENT

There are two ways of calibrating the compass depending on type of equipment to be connected. If connected to SimNet, the calibration and offset is carried out using the autopilot or instrument calibration menu. Refer to the autopilot or instrument manual.

Calibration data is stored in the compass and is presented on the autopilot and instrument display.

If connected to AT10 for NMEA0183 output only, the calibration procedure will start automatically if two consecutive turns of 360° are made within 5 minutes after (SimNet) power is applied.

